

HEX SETSCREWS (METRIC) - DIN 933 / ISO 4017

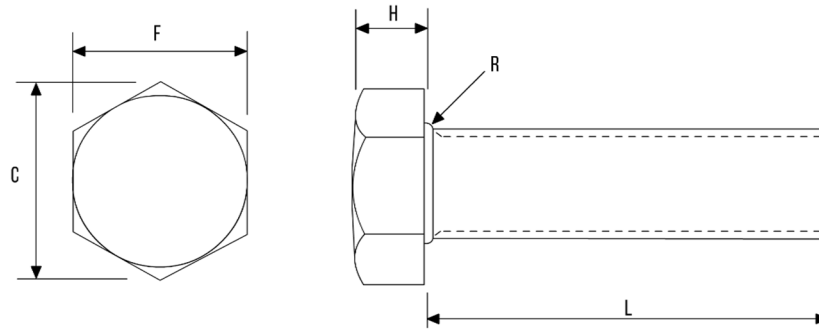

DIA	A/F	A/C	HEIGHT	RADIUS
M5	7.78 - 8.00	8.79	3.50	0.20
M6	9.78 - 10.00	11.05	4.00	0.25
M8	12.73 - 13.00	14.38	5.30	0.40
M10	15.73 - 16.00	17.77	6.40	0.40
M12	17.73 - 18.00	20.03	7.50	0.60
M14	20.67 - 21.00	23.36	8.80	0.60
M16	23.67 - 24.00	26.75	10.00	0.60
M18	26.67 - 27.00	30.14	11.50	0.60
M20	29.67 - 30.00	33.53	12.50	0.80
M22	33.38 - 34.00	37.72	14.00	0.80
M24	35.38 - 34.00	39.98	15.00	0.80
M27	40.00 - 41.00	45.20	17.00	1.00
M30	45.00 - 46.00	50.85	18.70	1.00
M33	49.00 - 50.00	55.37	21.00	1.00
M36	53.80 - 55.00	60.79	22.50	1.00
M39	58.80 - 60.00	66.44	25.00	1.00
M42	63.10 - 65.00	71.30	26.00	1.20
M45	68.10 - 70.00	76.95	28.00	1.20
M48	73.10 - 75.00	82.60	30.00	1.60
M52	78.10 - 80.00	88.25	33.00	1.60
M56	82.80 - 85.00	93.56	35.00	2.00
M60	87.00 - 90.00	99.21	38.00	2.00
M64	92.80 - 96.00	104.86	40.00	2.00

- Dimensions in millimetres
- Available in Grade 8.8, 10.9, 12.9 Steel and A2 & A4 Stainless Steel
- Other materials manufactured on request